

Connect your Equipment

Overview: The Zebra GX-420D Printer

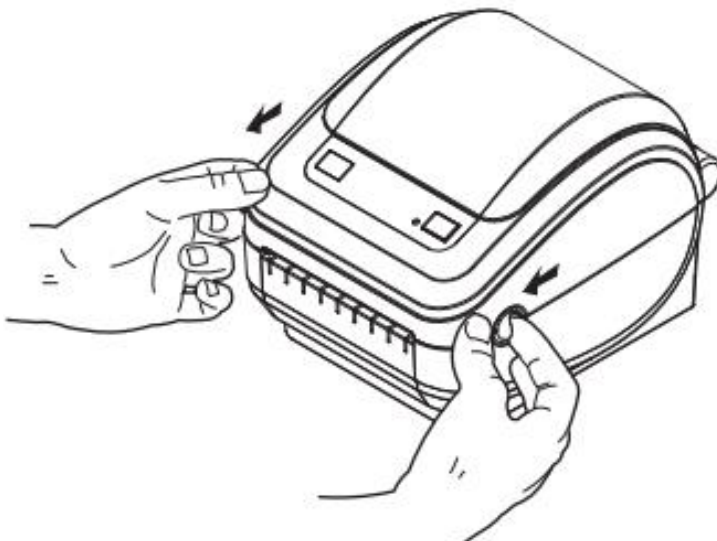
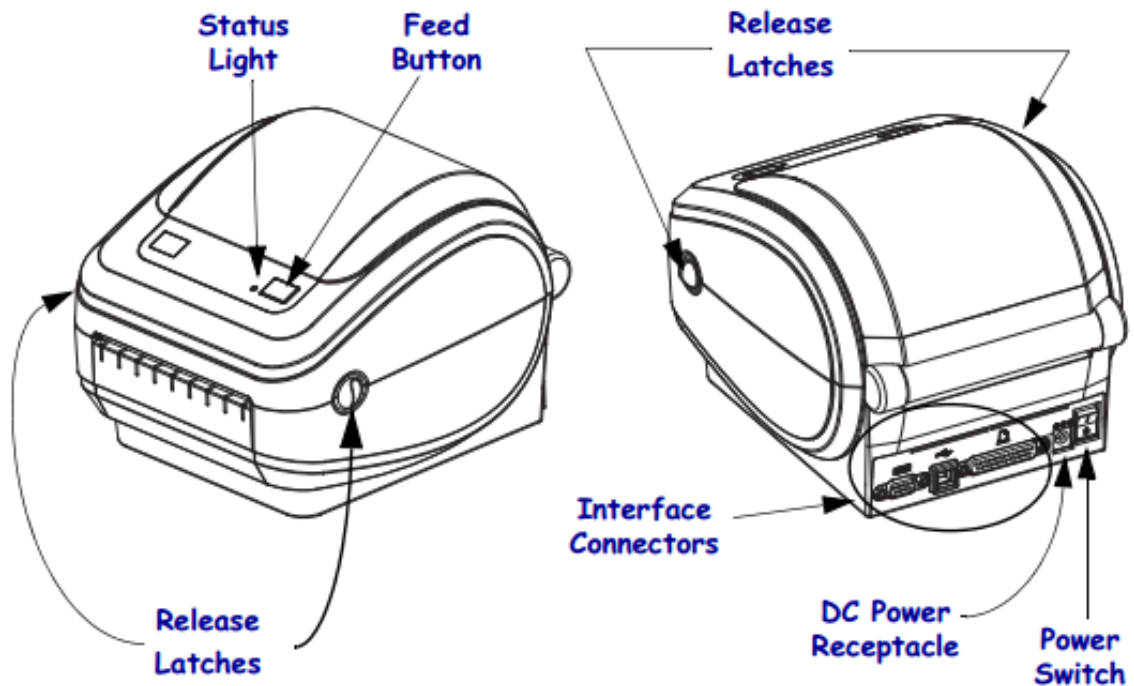

Open the Printer Cover / Printhead

To access the media compartment, you must open the printer. Pull the release latches towards you and lift the cover. Check the media compartment for loose or damaged components.

Load Fan-Fold Paper

1. Printing on fan-fold media requires you to adjust the media guide's stop position. Adjust the media guide stop position with the green thumb wheel. Rotate the wheel away from you to open the guides wider. Rotate the wheel towards you to make the media guide narrower.
2. Insert the media through the slot at the rear of the printer.
3. Run the media between the hangers.
4. Close the top cover

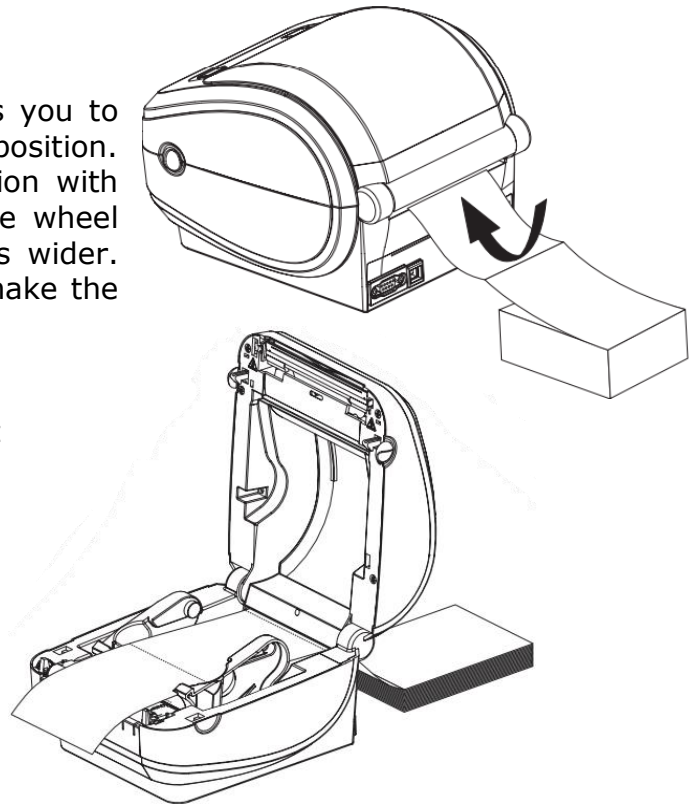

Connect the Ethernet Cable to the Router

1. Connect one end of the supplied Ethernet Cable into the Ethernet outlet of the Zebra Printer as shown below.

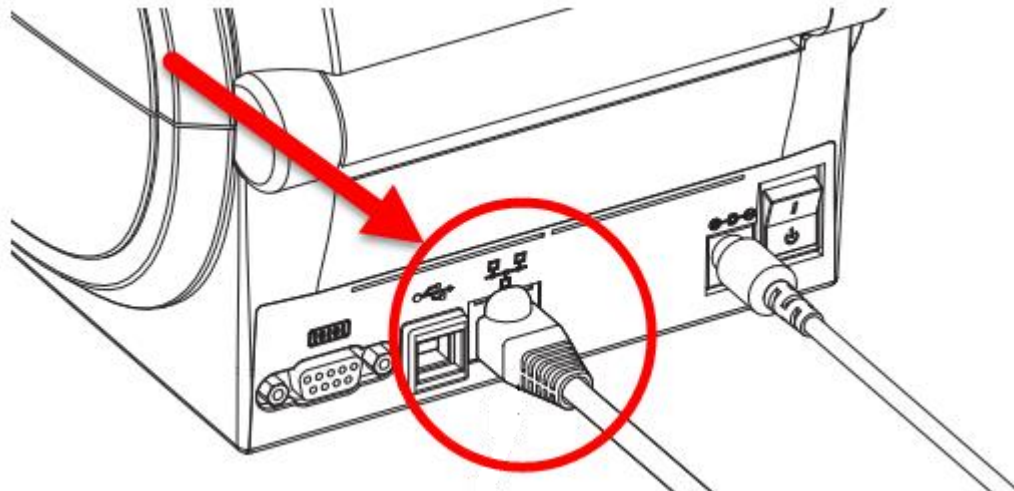

2. Connect the other end of the Ethernet Cable into the YELLOW outlets (number 1-4) of the Router.

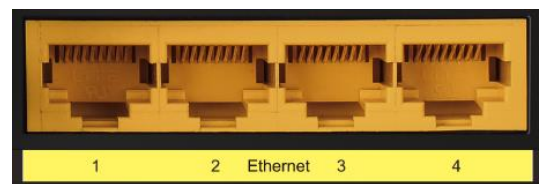

Connect the Printer to a Power Outlet

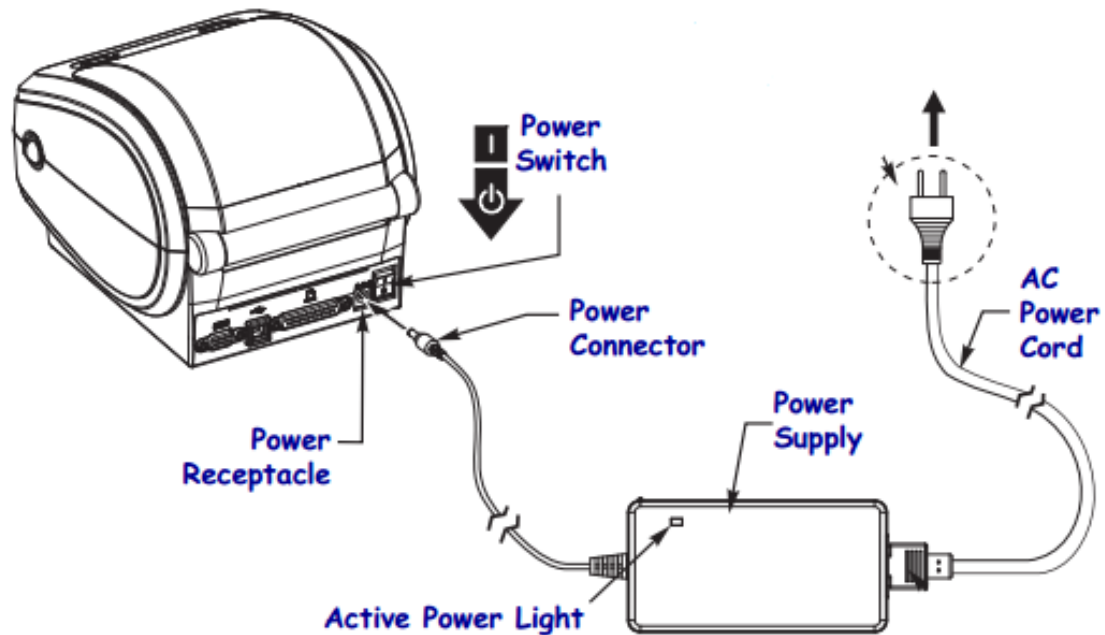

Power on the printer

Press up to turn ON or down to turn OFF the printer.

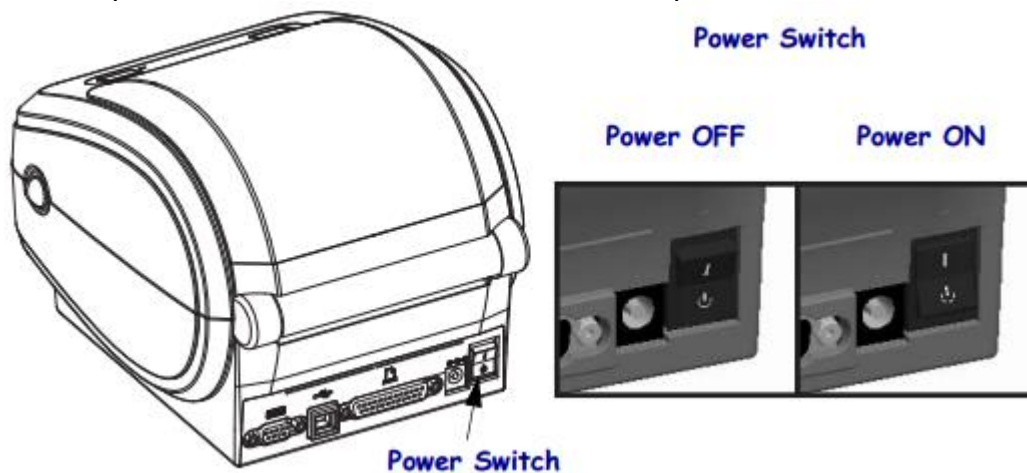

Calibrate the Printer

1. Make sure media is loaded
2. Turn on the printer power
3. Press and hold the Feed button until the green status light flashes once, then **twice** – now Release the Feed button
2. The printer will set the media sensor for the label being used. After it is done making this adjustment, the fanfold will automatically feed until a label is positioned at the printhead.
5. Press the Feed button. One entire blank label will feed.



Printing a test label

1. Make sure the media is properly loaded and the top cover of the printer is closed. Then, turn the printer power on if you have not already done so. If the printer initializes with the status light blinking green (pause mode), press the Feed button once to set the printer in Ready (to print) mode.
2. When the status light is solid green, press and hold the Feed button until the status light flashes once.
3. Release the Feed button. A configuration label will print

Resetting the Factory Default Values

Sometimes, resetting the printer to the factory defaults may solve some problems. Press and hold the Feed button until the green status light flashes **4 times** and **release** the Feed button.

LED Status and Color	Printer Status	Resolution
Off	Off	Turn on the printer; check the power connections
Solid Green	On	No action necessary
Solid Amber	Stopped	If this error occurs right after you turn on the printer, contact Choose 2 Rent for assistance. When the printer is operating normally, the printer status light will be amber for about 10 seconds before turning green
Flashing Green	Normal Operation	As soon as all of the data has been received, the status LED will turn green and the printer will automatically resume operation
Flashing Red	Stopped	The media is out - insert a new Paper roll and resume printing The printhead is open - close the top cover and press the Feed button to resume operations

Please call our support team if you need assistance setting up your rental devices - 1(800) 622-6484